

vtech[®]
baby

Instruction Manual

Sensory Sounds Musical Cube



VTech understands that a child's needs and abilities change as they grow and with that in mind we develop our toys to teach and entertain at just the right level...

vtech Baby

Toys that will stimulate their interest in different textures, sounds and colours

I am...

...responding to colours, sounds and textures

...understanding cause and effect

...learning to touch, reach, grasp, sit-up, crawl and toddle

Birth-36 months



Pre-School

Interactive toys to develop their imagination and encourage language development

I want...

...to get ready for school by starting to learn the alphabet and counting

...my learning to be as fun, easy and exciting as can be

...to show my creativity with drawing and music so my whole brain develops

3-6 years



Electronic Learning Computers

Cool, aspirational and inspiring computers for curriculum related learning

I need...

...challenging activities that can keep pace with my growing mind

...intelligent technology that adapts to my level of learning

...National Curriculum based content to support what I'm learning at school

4-10 years



To learn more about this and other VTech® products, visit www.vtech.co.uk

INTRODUCTION

Thank you for purchasing the **Sensory Sounds Musical Cube**.

Playtime comes from all sides on the **Sensory Sounds Musical Cube**! Get ready to jam with six animals and four instruments. Mini musicians can press any of the four sides to play musical sounds or layer them on top of each other to create their own mixes. Let's boogie!

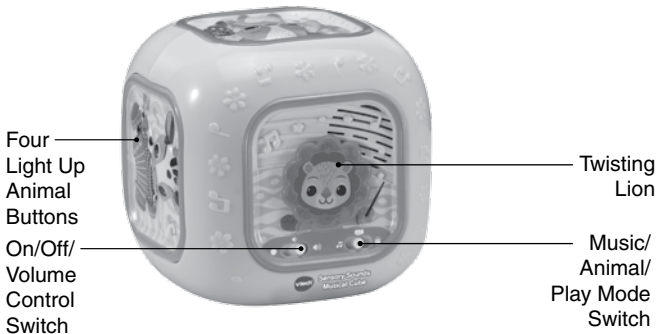

INCLUDED IN THE PACKAGE

- Sensory Sounds Musical Cube
- Quick Start Guide

WARNING

All packing materials such as tape, plastic sheets, packaging locks, removable tags, cable ties, cords and packaging screws are not part of this toy, and should be discarded for your child's safety.

NOTE

Please save this Instruction Manual as it contains important information.

Remove the packaging strips:

Please remove the battery door, then pull out the paper rope. Then securely reattach the battery door.

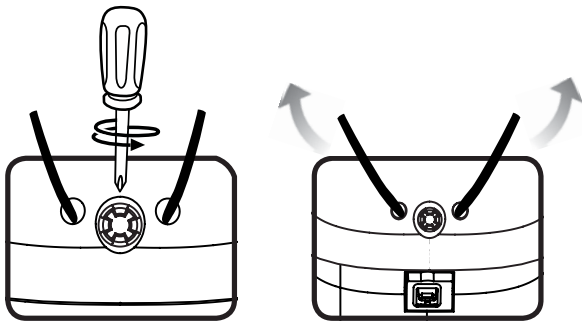

GETTING STARTED

Battery Removal and Installation

1. Make sure the unit is turned **Off**.
2. Find the battery cover located on the back of the unit, use a screwdriver to loosen the screw, and then open the battery cover.
3. If used batteries are present, remove these batteries from the unit by pulling up on one end of each battery.
4. Install 2 new AAA (AM-4/LR03) batteries following the diagram inside the battery box. (For best performance, alkaline batteries or fully charged Ni-MH rechargeable batteries are recommended.)
5. Replace the battery cover and tighten the screw to secure.

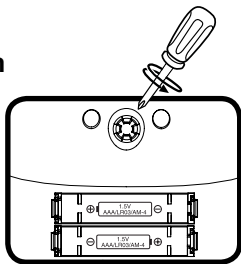

WARNING:

Adult assembly required for battery installation.

Keep batteries out of reach of children.

IMPORTANT: BATTERY INFORMATION

- Insert batteries with the correct polarity (+ and -).
- Do not mix old and new batteries.
- Do not mix alkaline, standard (carbon-zinc) or rechargeable batteries.
- Only batteries of the same or equivalent type as recommended are to be used.
- Do not short-circuit the supply terminals.
- Remove batteries during long periods of non-use.
- Remove exhausted batteries from the toy.
- Dispose of batteries safely. Do not dispose of batteries in fire.

RECHARGEABLE BATTERIES:

- Remove rechargeable batteries (if removable) from toy before charging.
- Rechargeable batteries are only to be charged under adult supervision.
- Do not charge non-rechargeable batteries.

Disposal of batteries and product



The crossed-out wheellie bin symbols on products and batteries, or on their respective packaging, indicates they must not be disposed of in domestic waste as they contain substances that can be damaging to the environment and human health.



The chemical symbols Hg, Cd or Pb, where marked, indicate that the battery contains more than the specified value of mercury (Hg), cadmium (Cd) or lead (Pb) set out in the Batteries and Accumulators Regulation.

The solid bar indicates that the product was placed on the market after 13th August, 2005.

Please dispose of your product and batteries responsibly. In the UK, give this toy a second life by disposing of it at a small electricals collection point* so all of its materials can be recycled.

Learn more at:



www.vtech.co.uk/recycle

www.vtech.com.au/sustainability

* Visit www.recyclenow.com to see a list of collection points near you.

PRODUCT FEATURES

1. On/Off/Volume Control Switch

To turn the unit **On**, slide the **On/Off/Volume Control Switch** to the Low Volume  or High Volume  position. You will hear fun sounds, a melody, phrases or a song in the selected mode. To turn the unit **Off**, slide the **On/Off/Volume Control Switch** to the **OFF**  position.

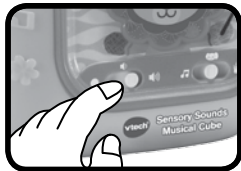

2. Music/Animal/Play Mode Switch

Slide the **Music/Animal/Play Mode Switch** to **Music** mode to hear a phrase and a melody. Slide to **Animal** mode to hear phrases and a song, or to **Play** mode to hear a song, and a short tune.



3. Automatic Shut-Off

To preserve battery life, the **Sensory Sounds Musical Cube** will automatically power down after approximately 50 seconds without input. The unit can be turned **ON** again by triggering any of the animal buttons or sliding to another mode.

NOTE

If the unit powers down or if the light fades out during play, please install a new set of batteries.

ACTIVITIES

1. Four Light Up Animal Buttons

Press the **Animal Buttons** to introduce instrument names and hear melodies in **Music** Mode. Hear animal sounds, names and sing-along songs in **Animal** Mode. To build a beat, play sounds, or hear the whole band for musical exploration switch to **Play** Mode. The lights will flash with the sounds.

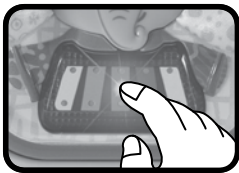

2. Squeaking Fox

Press the squeaking fox to hear fun squeaking sounds.



3. Twisting Lion

Twist the lion head left and right to hear a clicking sound.

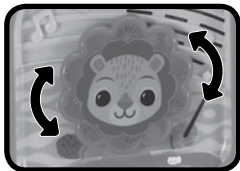

MELODIES

1. Swan Lake Waltz - Tchaikovsky
2. Air on a G String - Bach
3. Autumn Mvt 2 Adagio Capitalise molto - Vivaldi
4. Cello Suite No.1 in G - Bach
5. Für Elise - Beethoven
6. Spring Mvt 1 Allegro - Vivaldi
7. Rondo a Capriccio - Beethoven
8. Piano Sonata in C, K545 1st Movement - Mozart
9. Hello, Friend!
10. It's All About Friendship
11. Cheerful Moments
12. Dance Time
13. Incy Wincy Spider
14. Mary Had a Little Lamb
15. Skip to My Lou
16. Three Little Kittens

SONG LYRICS

Song 1

Let's tap, Let's bang, shake and squeeze,
Follow the tunes to play and sing!

Song 2

I'm a cute cow, squeezing my accordion makes me sing mooooo.

Song 3

I'm an elephant with soft ears, I love tapping my xylophone for loud cheers.

Song 4

I'm a cool cat, I love banging my drum.

Song 5

I'm a puppy, I love to shake, shake, shake with my maracas!

CARE & MAINTENANCE

1. Keep the unit clean by wiping it with a slightly damp cloth.
2. Keep the unit out of direct sunlight and away from any direct heat sources.
3. Remove the batteries if the unit will not be in use for an extended period of time.
4. Do not drop the unit on a hard surface and do not expose the unit to moisture or water.

TROUBLESHOOTING

If for some reason the unit stops working or malfunctions, please follow these steps:

1. Please turn the unit **Off**.
2. Interrupt the power supply by removing the batteries.
3. Let the unit stand for a few minutes, then replace the batteries.
4. Turn the unit **On**. The unit should now be ready to play again.
5. If the unit still does not work, install a new set of batteries.

CONSUMER SERVICES

Creating and developing **VTech®** products is accompanied by a responsibility that we at **VTech®** take very seriously. We make every effort to ensure the accuracy of the information, which forms the value of our products. However, errors sometimes can occur. It is important for you to know that we stand behind our products and encourage you to call our Consumer Services Department with any problems and/or suggestions that you might have. A service representative will be happy to help you.

UK Customers:

Phone: 0330 678 0149 (from UK) or +44 330 678 0149 (outside UK)
Website: www.vtech.co.uk/support

Australian Customers:

Phone: 1800 862 155
Website: support.vtech.com.au

NZ Customers:

Phone: 0800 400 785
Website: support.vtech.com.au

PRODUCT WARRANTY/ CONSUMER GUARANTEES

UK Customers:

Read our complete warranty policy online at vtech.co.uk/warranty.

Australian Customers:

VTECH ELECTRONICS (AUSTRALIA) PTY LIMITED –
CONSUMER GUARANTEES

Under the Australian Consumer Law, a number of consumer guarantees apply to goods and services supplied by VTech Electronics (Australia) Pty Limited. Please refer to vtech.com.au/consumerguarantees for further information.

**Visit our website for more
information about our products,
downloads, resources and more.**

www.vtech.co.uk
www.vtech.com.au

